

| BENCHMARK DATA | | | | |
|----------------|-----------|-------|----------|-------------------|
| BM #1 STA. | 8+49.73, | ELEV. | 1041.44, | OFFSET 13.27', LT |
| BM #2 STA. | 10+91.80, | ELEV. | 1043.27, | OFFSET 17.10', LT |
| BM #3 STA. | | ELEV. | | OFFSET |
| BM #4 STA. | | ELEV. | | OFFSET |

FOR ADDITIONAL BENCHMARK INFORMATION. SEE ROADWAY PLAN SHEET 2.

NOTES

1. EARTHWORK LIMITS SHOWN ARE APPROXIMATE. ACTUAL SLOPES SHALL CONFORM TO PLAN CROSS SECTIONS.

2. SEE RAILROAD SUPPLEMENTAL SITE PLAN ON SHEET 2 OF 28 FOR CSX RIGHT-OF-WAY AND ADDITIONAL INFORMATION.

DESIGN TRAFFIC:
2021 ADT = 1,000
2041 ADT = 1,500

LEGEND

PROJECT BORING LOCATION

| VERTICAL CLEARANCE | | | |
|--------------------|----------|----------------|----------------|
| EXISTING | REQUIRED | PROVIDED | |
| 20'-6" | 23'-0" | "A" 23'-3 3/4" | "B" 23'-6 7/8" |
| | | "C" 23'-2 1/4" | |

EXISTING STRUCTURE

TYPE: 5 SPAN CONTINUOUS T-BEAMS
ON INTEGRAL ABUTMENTS AND PIERS

SPANS: 21'-6", 21'-6", 38'-0", 21'-6", 21'-6"
ROADWAY: 24'-0"
LOADING: H15
SKEW: NONE
WEARING SURFACE: MONOLITHIC CONCRETE
APPROACH SLABS: NONE
ALIGNMENT: TANGENT
CROWN: 3/16" PER FOOT
STRUCTURE FILE NUMBER: 7561156
DATE BUILT: 1924
DISPOSITION: TO BE REPLACED

PROPOSED STRUCTURE

TYPE: 3-SPAN STEEL ROLLED BEAM ON SEMI-INTEGRAL ABUTMENTS AND T-TYPE PIERS

SPANS: 26'-3", 97'-6", 26'-3"
ROADWAY: 24'-0"
LOADING: HL93 AND 60PSF FUTURE WEARING SURFACE
SKEW: NONE
WEARING SURFACE: MONOLITHIC CONCRETE
APPROACH SLABS: 20'-0", 30'-0" LONG (AS-1-15, AS-2-15)
ALIGNMENT: TANGENT
CROWN: 0.016 FT/FT
DECK AREA: 5,956 SF
STRUCTURE FILE NUMBER: 7561157
COORDINATES: LATITUDE 40°16'25.83" LONGITUDE 84°9'50.83"

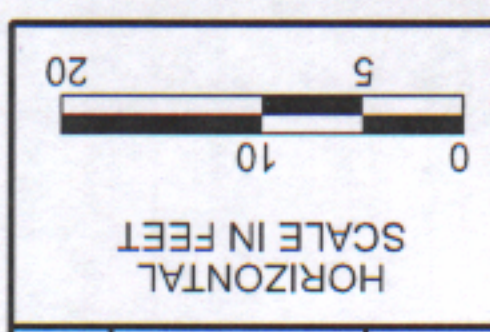
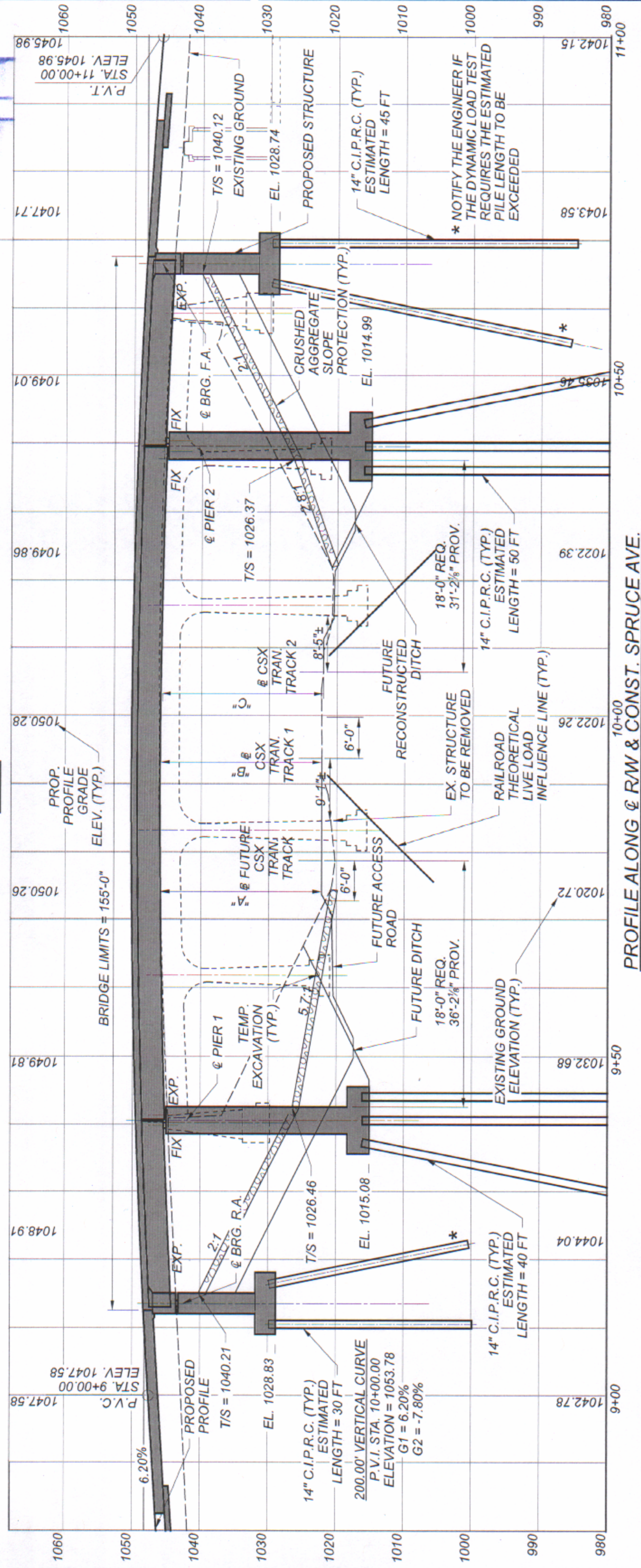

SITE PLAN

BRIDGE NO. SHE-SPRUC-0227

STA. 9+32.54 TO STA. 10+67.54

SPN 7561157
DESIGN AGENCY

DESIGNER/CHECKER
JLM AMT
REVIEWER
DWS 05/30/23
PROJECT ID
114201
SUBSET
TOTAL 28
SHEET 39
TOTAL 72